

PLAT OF SURVEY

UNIT 38-27
GENEVA NATIONAL CONDOMINIUM
NO. 38
LOCATED IN TOWN 2 NORTH, RANGE 17 EAST
WALWORTH COUNTY, WISCONSIN

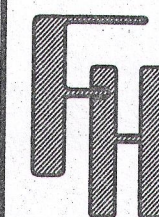

WORK ORDERED BY
MIKE FASSBINDER
PO BOX 332
GRAYS LAKE, IL 60030

FARRIS, HANSEN & ASSOCIATES, INC.
Engineering, Architecture, Surveying
7 Ridgway Court P.O. Box 437
ELKHORN, WISCONSIN 53121
Office: (414) 723-2098
Fax: (414) 723-5886

REVISIONS

PROJECT NO.
3269.38.27
DATE:
04/21/03
SHEET NO.
1 OF 1

UNIT 38-27

UNIT 38-27
31,139 S.F.

UNIT 18-30

UNIT 38-29

UNIT 38-28

- = FOUND IRON REBAR STAKE
- ⊙ = SET IRON REBAR STAKE
- (XXX) = RECORDED AS

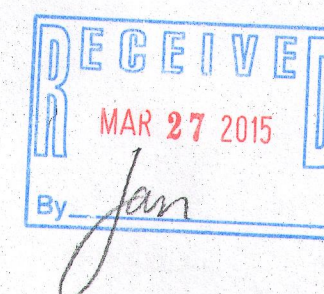
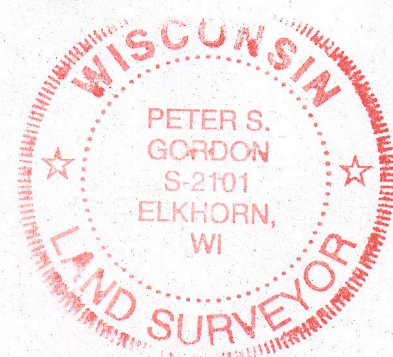

NOTE: COPIES OF THIS MAP TO WHICH THE FOLLOWING CERTIFICATE WILL APPLY. SHOW SURVEYOR'S ORIGINAL SEAL AND SIGNATURE IN RED INK. COPIES BY ANY OTHER MEANS MAY HAVE ALTERATIONS WHICH DO NOT REPRESENT THE SURVEYOR'S WORK PRODUCT.

I HEREBY CERTIFY THAT THE ABOVE DESCRIBED PROPERTY HAS BEEN SURVEYED UNDER MY DIRECTION AND THAT THE ABOVE MAP IS A TRUE REPRESENTATION THEREOF AND SHOWS THE SIZE AND LOCATION OF THE PROPERTY AND ITS EXTERIOR BOUNDARIES. THIS SURVEY IS MADE FOR THE USE OF THE PRESENT OWNERS OF THE PROPERTY, AND ALSO THOSE WHO PURCHASE, MORTGAGE, OR GUARANTEE THE TITLE THERETO WITHIN ONE YEAR FROM THE DATE HEREOF.

DATED: APRIL 21, 2003

REVISED 03-06-2015
TO SHOW AS BUILT IMPROVEMENTS

PETER S. GORDON R.L.S. 2101

MAP SCALE IN FEET ORIGINAL 1" = 20'

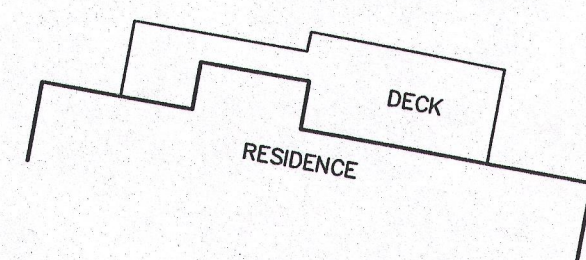

MAR 06 2015

JGN 38-27

212-4049